



FLEMINGS

HOTELS

Flemings Hotel Wien-Stadthalle
Neubaugürtel 26-28
1070 Vienna



Contact

+43 1 227 37-0
 Event sales: +43 1 227 37-5016
 conference.vic@flemings-hotels.com
 www.flemings-hotels.com



Mobility

14 parking spaces / 2 electric charging stations (Tesla-compatible) / opposite Vienna Westbahnhof



Distances

Wien Westbahnhof 0.5 km / Mariahilfer Straße 0.5 km / Wiener Stadthalle 0.5 km / city centre 2.3 km / central train station 4.2 km / exhibition and congress centre 7.5 km / airport 19 km / Prater 5.5 km / Naschmarkt 1.9 km / Schönbrunn Palace 2.6 km

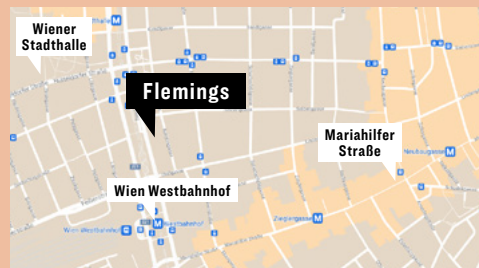

ENJOY YOUR STAY IN VIENNA!

Rooms

168 rooms and 5 suites / extra comfortable box-spring bed / soundproofed windows / individually adjustable air-conditioning / free high-speed WiFi / laptop-size safe / free bottle of mineral water / flat-screen TV with radio / comfortable work corner / glass and granite bathroom / high-quality Malin+Goetz skincare products / coffee and tea set / non-smoking rooms only / quick and easy self-check-in / no check-out necessary

Cuisine

Hearty, regional breakfast buffet / restaurant / bar / international and regional specialties

Fitness & wellness

Sauna / natural sauna / relaxation area / gym



Technical equipment









With modern Jabra-PanaCast video conferencing technology, you can host high-quality hybrid meetings (up to 10 people)

State-of-the-art conference technology such as ClickShare systems for easy presentation sharing / WiFi / projectors / screens / cameras and other technical equipment also provided

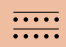
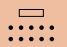

Service

Exclusive meetings concierge at your disposal for the duration of your stay / in-room dining if desired / greatly enhanced corona safety concept, the Flemings Feel Safe Promise

										
Function rooms	Floor	Height	Surface area	Natural light	Classroom seating plan	Theatre	Banquet	Reception	U-shaped	Conference style
Library	GF	3.50 m	64.3 m ²	yes	–	–	–	–	–	20 (10)*
Room 1	B1	3.20 m	57.3 m ²	yes	20 (10)*	46 (12)*	20	60	20 (8)*	20 (10)*
Room 2	B1	3.20 m	63.2 m ²	yes	20 (10)*	51 (12)*	40	50	19 (8)*	20 (10)*
Room 3	B1	3.20 m	57.2 m ²	yes	20 (10)*	42 (12)*	30	50	19 (8)*	16 (10)*
Room 4	B1	3.20 m	135.3 m ²	yes	73 (30)*	125 (30)*	70	130	28 (12)*	32 (13)*
Room 5	B1	3.20 m	94.3 m ²	no	53 (21)*	93 (20)*	40	90	31 (11)*	32 (12)*
Room 6	B2	3.20 m	57.3 m ²	yes	20 (10)*	46 (12)*	20	60	20 (8)*	20 (10)*
Room 7	B2	3.20 m	63.2 m ²	yes	20 (10)*	51 (12)*	40	50	19 (8)*	20 (10)*
Room 8	B2	3.20 m	59.2 m ²	yes	20 (10)*	43 (12)*	30	50	19 (8)*	16 (10)*
Room 9	B2	3.20 m	135.5 m ²	yes	73 (30)*	125 (30)*	70	130	28 (12)*	32 (13)*
Room 10	B2	3.20 m	96.2 m ²	no	53 (21)*	95 (20)*	50	90	31 (11)*	32 (12)*
Room 2+3	B1	3.20 m	120.3 m ²	yes	65 (24)*	105 (26)*	70	110	30 (14)*	36 (14)*
Room 4+5	B1	3.20 m	229.8 m ²	yes	150 (50)*	218 (50)*	130	220	42 (16)*	64 (16)*
Room 7+8	B2	3.20 m	122.3 m ²	yes	65 (24)*	105 (26)*	70	110	30 (14)*	36 (14)*
Room 9+10	B2	3.20 m	231.7 m ²	yes	150 (50)*	218 (50)*	130	220	42 (16)*	64 (16)*

*socially distanced seating plan

FLEMINGS HOTELS

Function rooms
Ground Floor

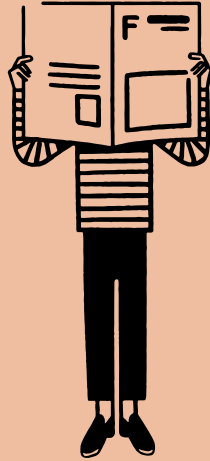

OUR FUNCTION ROOMS

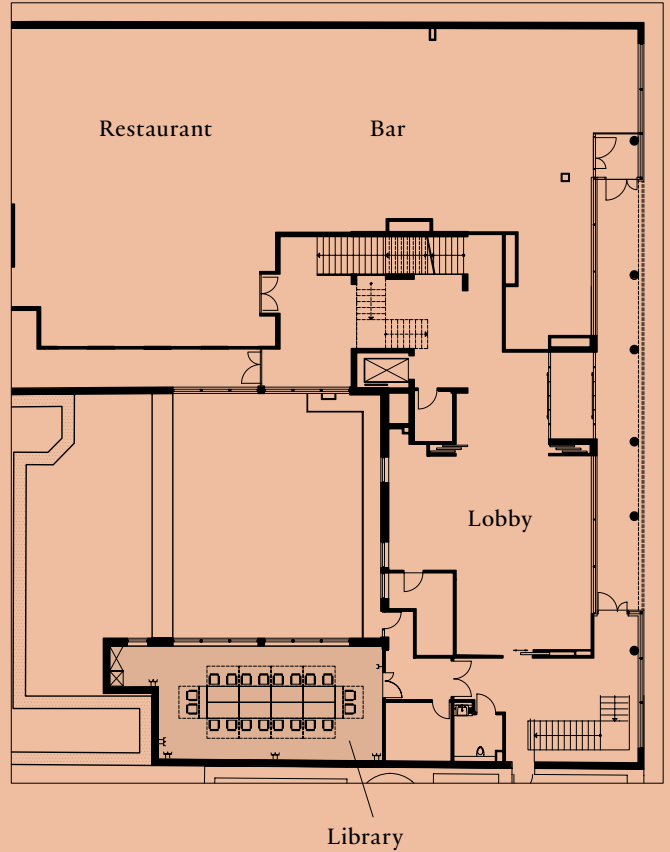

Function rooms
Basement 1



Function rooms
Basement 2

